

Passport Photo Guidelines

Please find below the photo guidelines for submitting a passport photo to EMGS. Kindly note that this is important since the same picture will be used on the Immigration System as well as printed on the iKad.

Institutions will be requested to adhere to the guidelines below to avoid any delay in processing as well as avoiding any untoward issues with law enforcement officials checking the iKad.

1. In colour and identical, not black and white
2. Taken against a **WHITE** background
3. Your photos must be **professionally printed** and **45 millimetres (mm) high x 35mm wide**. **Please do not use photos that have been cut down from larger pictures**. In the examples below, the one on the *left* shows the *correct proportions*. The image on the right shows incorrect proportions.

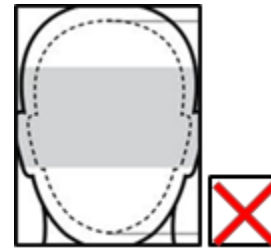
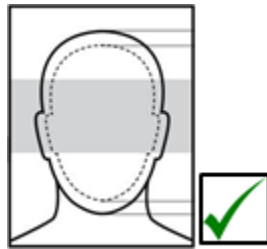

4. **Note to Institutions:** When scanning and uploading the passport picture in STARS please ensure that there is **no white border** surrounding the photo as this may affect the dimensions of the image. Therefore, please remove the white border before uploading the student's picture. In the examples below, the *one on the left* shows the *correct proportions*. The image on the right shows incorrect proportions.

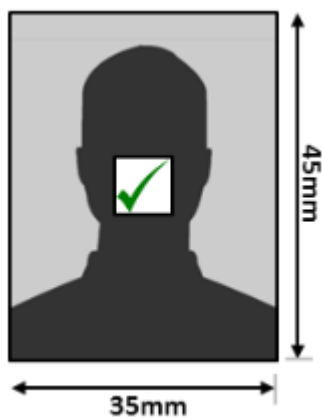

5. Free from reflection or glare on spectacles, the frames of which must not cover the eyes. **We recommend photographs without spectacles to avoid the risk of rejection because of glare or reflection.**
6. Because clothing is visible in the passport photo, subjects should be careful to wear something modest. We recommend that you wear dark-coloured attire (this includes headscarves) so as to be in clear contrast to the white background. A conservative top is best. **Do not wear something with open shoulders (such as a tank top).**
7. Free from shadows.
8. Digital enhancements or changes are not acceptable.
9. Taken with the eyes open and clearly visible (with no sunglasses or tinted spectacles, and no hair across the eyes) - if possible.
10. With the subject facing forward, looking straight at the camera.
11. With a neutral expression with the mouth closed (no grinning, frowning or raised eyebrows).
12. Of each person on their own (no objects such as dummies or toys, or other people visible).
13. Taken with nothing covering the face.
14. In sharp focus and clear.
15. Free from "redeye".
16. Taken of the full head, without any covering unless worn for religious or medical reasons.
17. Make sure the facial features are clearly visible, from the bottom of the chin to the crown of the head.
18. Printed professionally or taken in a passport photo booth. Photos printed at home are unlikely to be of an acceptable standard.
19. Have the person's full name on the back of each photograph (when submitted manually).

Examples of background photos

Compare background photos with these examples before submitting an application.

Examples of acceptable photos



Examples of unacceptable photos

